

**EXISTING FLOOR PLAN**  
 SCALE: 3/32" = 1'-0"

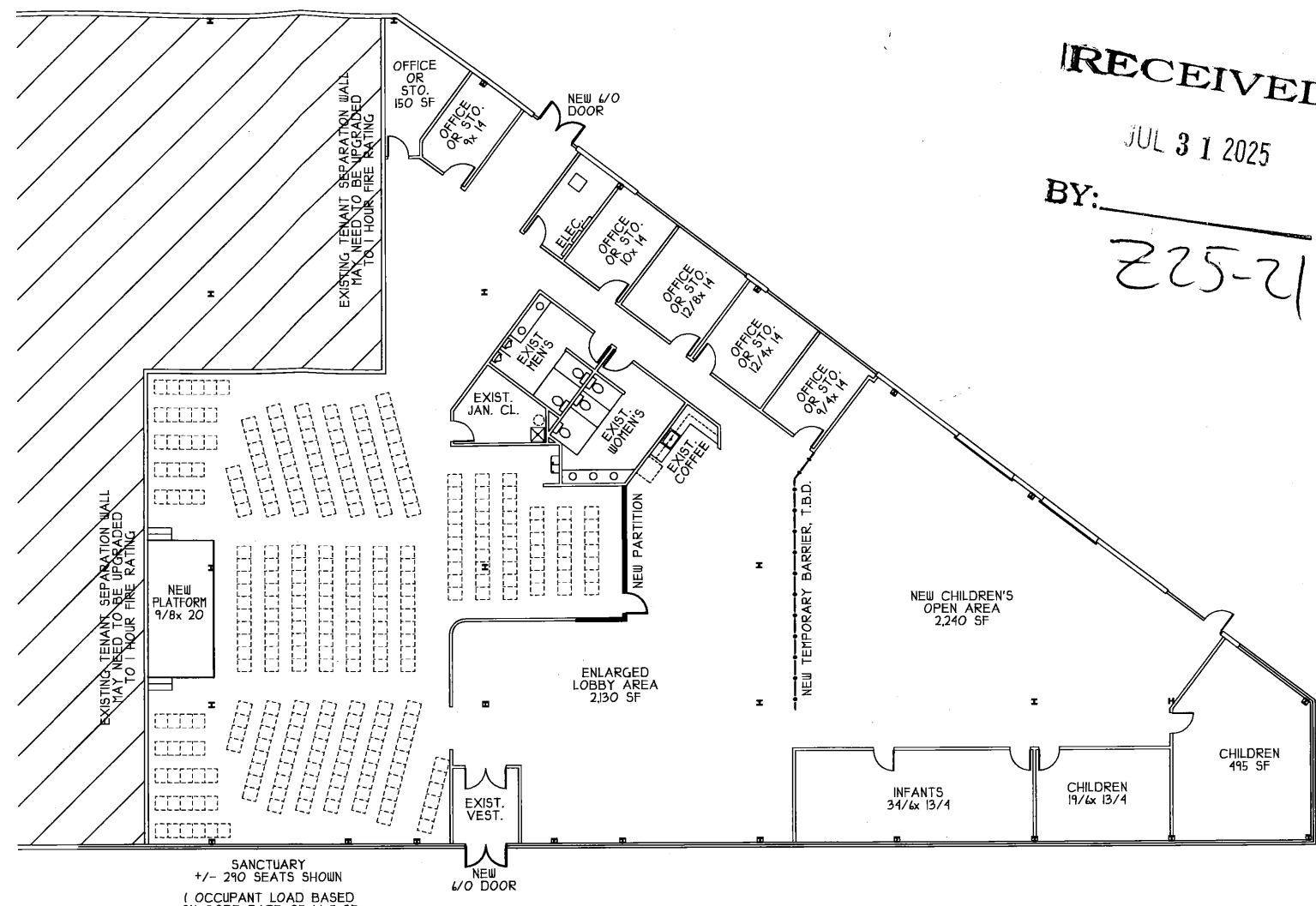

SANCTUARY  
 +/- 290 SEATS SHOWN  
 ( OCCUPANT LOAD BASED  
 ON CODE RATE OF 1/1 SF  
 488 PEOPLE )

**PRELIMINARY FLOOR PLAN**  
 SCALE: 3/32" = 1'-0" SUITE SIZE = 12,244 SF

- EXISTING TENANT SEPARATION WALL MAY NEED TO BE UPGRADED TO 1 HOUR FIRE RATING
- ALL EXIT DOORS WILL BE REQUIRED TO HAVE PANIC PUSH BAR HARDWARE.
- EXISTING HVAC SYSTEM TO BE VERIFIED FOR NEW OCCUPANCY
- FIRE ALARM SYSTEM TO BE ALTERED AS REQUIRED BY NEW AREAS
- ADDITIONAL CHANGE OF USE REQUIREMENTS, T.B.D.

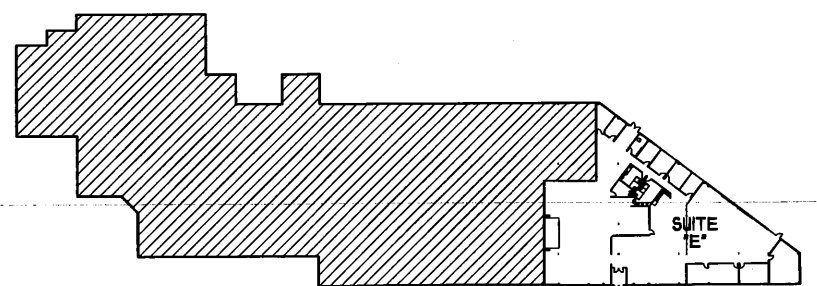

**BUILDING KEY PLAN**  
 NO SCALE

**RECEIVED**  
 JUL 31 2025  
 BY: 225-21

THIS DOCUMENT IS THE PROPERTY OF HARRY D. BOPP ARCHITECT AND COMPANY. IT IS TO BE USED ONLY FOR THE PROJECT AND SITE SPECIFICALLY IDENTIFIED HEREIN. IT IS NOT TO BE REPRODUCED OR TRANSMITTED IN ANY FORM OR BY ANY MEANS, WITHOUT WRITTEN AUTHORIZATION.

HARRY D. BOPP AIA  
 ARCHITECT  
 2 E. MAIN STREET - SUITE # 100 - REDFORD, NEW JERSEY 08066  
 HARRY D. BOPP ARCHITECT N.J. # 0001

PROPOSED INTERIOR TENANT RENOVATIONS TO EXISTING BUILDING FOR:  
**FOUR ANCHORS CHURCH**  
 1 EAST STONING ROAD  
 EYESHAM TOWNSHIP, NEW JERSEY

EXISTING FLOOR PLAN AND PRELIMINARY FLOOR PLAN

REVISION	DATE
PROGRESS DWG	5-16-25

DATE: 5-15-25  
 BY: .  
 CHECKED:  
 COMM. NO. 19 - 5/25  
 SHEET NUMBER  
**SK-1**  
 ONE OF ONE