

- LEGEND**
- 205 --- EXISTING MAJOR CONTOUR
  - 201 --- EXISTING MINOR CONTOUR
  - 218 • EXISTING SPOT ELEVATION
  - ⊕ BENCHMARK (SEE NOTES FOR ELEV.)
  - ⊙ SEPTIC LID
  - ⊕ ELECTRIC METER
  - ⊕ GAS METER
  - ⊕ GAS VALVE
  - ⊕ WATER VALVE
  - ⊕ AIR CONDITIONING UNIT
  - ⊕ CLEANOUT
  - ⊕ ROOF DRAIN
  - ⊕ PEST CONTROL STATION
  - ⊕ MAIL BOX
  - ⊕ FLAG POLE
  - G --- APPROX. LOC. UNDERGROUND NATURAL GAS LINE
  - A26 --- WETLANDS LINE WITH FLAG NUMBER
  - FEMA FLOOD HAZARD BOUNDARY
  - PROPERTY LINE
  - ADJACENT PROPERTY LINE
  - ROAD RIGHT-OF-WAY LINE
  - TREE DRIP LINE
  - ⊕ BOUNDARY EVIDENCE
  - ⊕ DECIDUOUS TREE
  - ⊕ CONIFEROUS TREE
  - ⊕ SHRUB
  - ⊕ BFE BASE FLOOD ELEVATION
  - CLF --- CHAIN LINK FENCE
  - CONC --- CONCRETE
  - EOG --- EDGE OF GRAVEL
  - EOP --- EDGE OF PAVEMENT
  - FFE --- FIRST FLOOR ELEVATION
  - LSA --- LANDSCAPED AREA
  - MC --- METAL COVER
  - MON --- MONUMENT
  - TYP --- TYPICAL

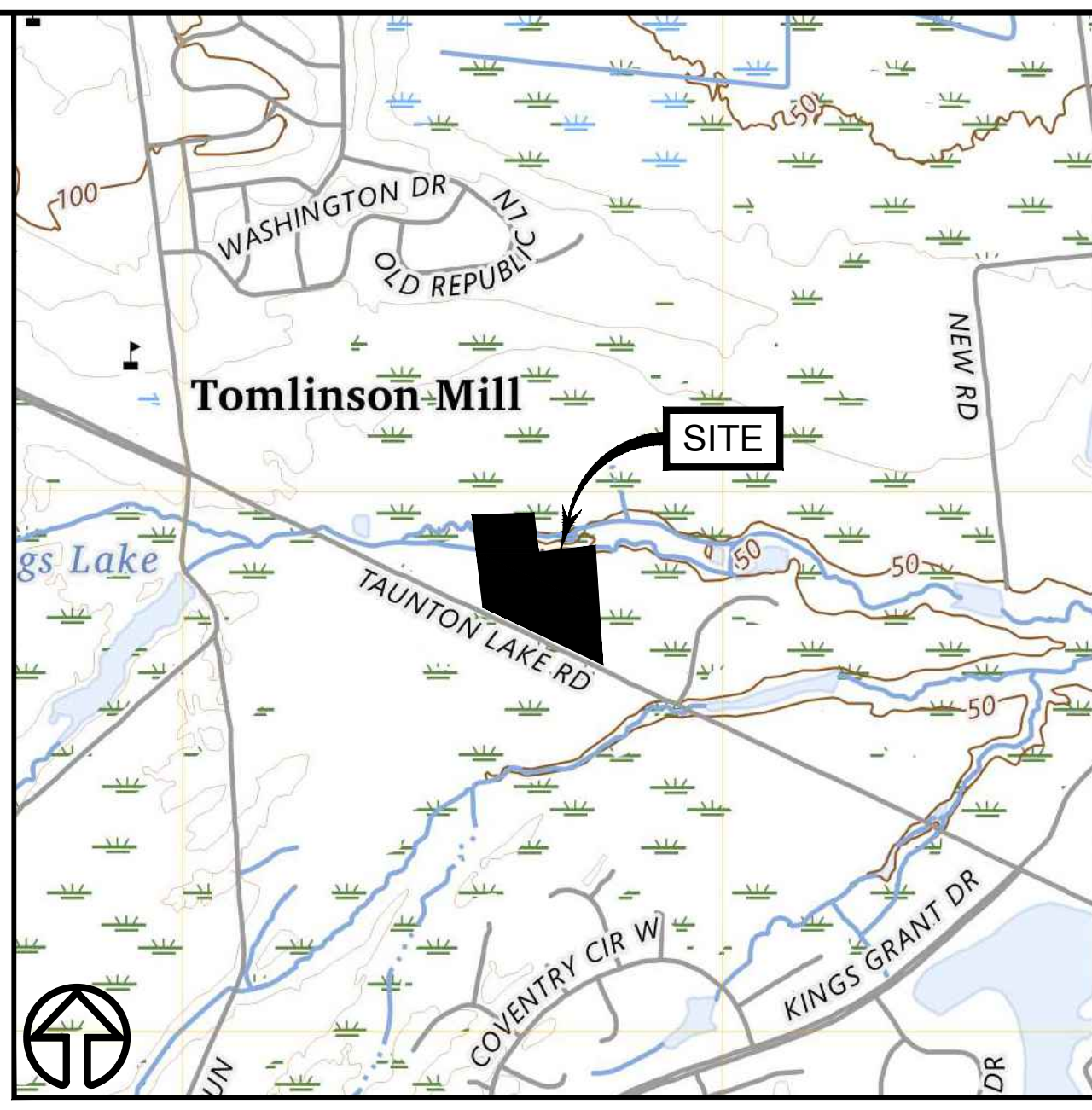

VICINITY MAP  
U.S.G.S. QUADRANGLE  
"CLEMONTON"  
(NOT TO SCALE)

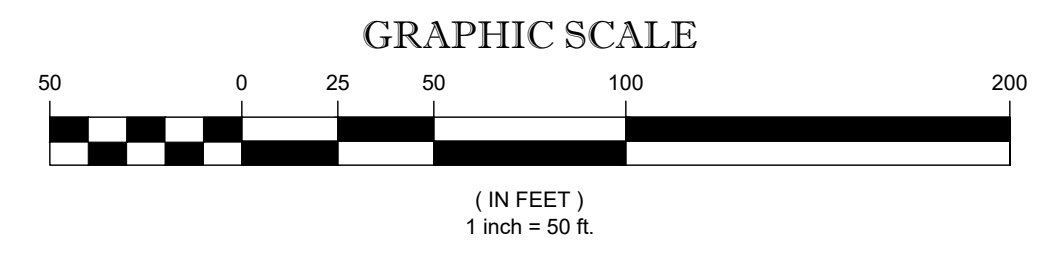

- NOTES:**
- PROPERTY KNOWN AS BLOCK 38, LOTS 8.01, 9.01 & 10, AS SHOWN ON THE OFFICIAL TAX MAP FOR EVESHAM TOWNSHIP, BURLINGTON COUNTY, NEW JERSEY.
  - AREA COMBINED LOTS 8.01 & 10= 359,514 S.F. OR 8.253 AC. AREA OF LOT 9.01= 86,740 S.F. OR 1.991 AC.
  - LOCATION OF UNDERGROUND UTILITIES ARE APPROXIMATE. LOCATIONS AND SIZES ARE BASED ON UTILITY MARK-OUTS, ABOVE GROUND STRUCTURES THAT WERE VISIBLE & ACCESSIBLE IN THE FIELD, AND THE MAPS AS LISTED IN THE REFERENCES AVAILABLE AT THE TIME OF THE SURVEY. AVAILABLE AS-BUILT PLANS AND UTILITY MARKOUT DOES NOT ENSURE MAPPING OF ALL UNDERGROUND UTILITIES AND STRUCTURES. BEFORE ANY EXCAVATION IS TO BEGIN, ALL UNDERGROUND UTILITIES SHOULD BE VERIFIED AS TO THEIR LOCATION, SIZE, AND TYPE BY THE PROPER UTILITY COMPANIES. CARROLL ENGINEERING DOES NOT GUARANTEE THE UTILITIES SHOWN COMPRISE ALL SUCH UTILITIES IN THE AREA, EITHER IN SERVICE OR ABANDONED.
  - THIS PLAN IS BASED ON INFORMATION PROVIDED BY THE CLIENT, A FIELD SURVEY PREPARED BY CARROLL ENGINEERING, AS WELL AS OTHER REFERENCE MATERIAL AS LISTED HEREON.
  - THIS SURVEY WAS PREPARED WITHOUT THE BENEFIT OF A TITLE REPORT AND IS SUBJECT TO THE RESTRICTIONS, COVENANTS AND/OR EASEMENTS THAT MAY BE CONTAINED THEREIN. IT IS STRONGLY RECOMMENDED THAT A COMPLETE TITLE SEARCH BE PROVIDED TO THE SURVEYOR FOR REVIEW PRIOR TO THE PLACEMENT OF OR ALTERATION TO IMPROVEMENTS ON THE PROPERTY.
  - EXISTING FIRM: BY GRAPHIC PLOTTING ONLY PROPERTY IS LOCATED IN FLOOD HAZARD ZONE AE (SPECIAL FLOOD HAZARD AREAS SUBJECT TO INUNDATION BY THE 1% ANNUAL CHANCE FLOOD). (THE 1% ANNUAL CHANCE FLOOD (100-YEAR FLOOD), ALSO KNOWN AS THE BASE FLOOD, IS THE FLOOD THAT HAS A 1% CHANCE OF BEING EQUALLED OR EXCEEDED IN ANY GIVEN YEAR. THE SPECIAL FLOOD HAZARD AREA IS THE AREA SUBJECT TO FLOODING BY THE 1% ANNUAL CHANCE FLOOD. AREAS OF SPECIAL FLOOD HAZARD INCLUDE ZONES A, AE, AH, AO, AR, A99, V AND VE. THE BASE FLOOD ELEVATION IS THE WATER-SURFACE ELEVATION OF THE 1% ANNUAL CHANCE FLOOD.) (BASE FLOOD ELEVATION = 52.0' (NAVD88)). ALSO THE PROPERTY IS LOCATED IN FLOOD HAZARD ZONE X (OTHER FLOOD AREAS). (AREAS OF 0.2% ANNUAL CHANCE FLOOD; AREAS OF 1% ANNUAL CHANCE FLOOD WITH AVERAGE DEPTHS OF LESS THAN FOOT OR WITH DRAINAGE AREAS LESS THAN 1 SQUARE MILE; AND AREAS PROTECTED BY LEVEES FROM 1% ANNUAL CHANCE FLOOD). PER REF. #2.
  - THE EXISTENCE OF UNDERGROUND STORAGE TANKS, IF ANY, WAS NOT KNOWN AT THE TIME OF THE FIELD SURVEY.
  - ELEVATIONS REFER TO THE NORTH AMERICAN VERTICAL DATUM OF 1988 (NAVD88), BASED ON GPS OBSERVATIONS UTILIZING THE KEYSTONE VRS NETWORK (KEYNETGPS). TEMPORARY BENCH MARK SET: TBM-A: MAG NAIL SET IN DRIVEWAY ENTRANCE ELEVATION= 56.33'
- PRIOR TO CONSTRUCTION IT IS THE CONTRACTOR'S RESPONSIBILITY TO VERIFY THAT THE BENCHMARKS ILLUSTRATED ON THIS SKETCH HAVE NOT BEEN DISTURBED AND THEIR ELEVATIONS HAVE BEEN CONFIRMED. ANY CONFLICTS MUST BE REPORTED PRIOR TO CONSTRUCTION.
- THE OFFSETS SHOWN ARE NOT TO BE USED FOR THE CONSTRUCTION OF ANY STRUCTURE, FENCE, PERMANENT ADDITION, ETC.
  - A WRITTEN WAIVER AND DIRECTION NOT TO SET CORNER MARKERS HAS BEEN OBTAINED FROM THE ULTIMATE USER PURSUANT TO P.L. 2003, C. 14 (N.J.S.A. 45:8-36.3) AND N.J.A.C. 13:40-5.1 (d).
  - THE WETLANDS LIMITS SHOWN ON THIS SURVEY ARE BASED ON WETLANDS FIELD IDENTIFICATION MARKERS PLACED BY DAVEY RESOURCE GROUP ON 10-01-2024, AND FIELD LOCATED BY CARROLL ENGINEERING ON 10-01-2024. AT THE TIME OF THIS MAPPING, SAID WETLAND BOUNDARY LIMITS ARE SUBJECT TO CONFIRMATION BY NJDEP.
  - PARTIAL TOPOGRAPHY SHOWN HEREON PER CONTRACTUAL AGREEMENT WITH THE CLIENT.
  - THE VESTING DEED FOR THE SURVEYED PROPERTY CALLS TO THE MEANDER LINE OF THE STREAM. MEASUREMENTS TO SAID MEANDER LINE MAY VARY AS THE STREAM LOCATION NATURALLY FLUCTUATES ACROSS TIME.
  - THE VESTING DEED FOR THE SURVEYED PROPERTY CALLS TO THE CENTERLINE OF THE ROAD. HOWEVER, BEARINGS AND DISTANCES ARE SHOWN HEREON TO THE EXISTING RIGHT-OF-WAY LINE PER COUNTY MAPPING (REF. #3), WHICH IS 24.75' FEET OFF THE DEEDED CENTERLINE AT RIGHT ANGLES.

- REFERENCES:**
- THE OFFICIAL TAX ASSESSOR'S MAP OF EVESHAM TOWNSHIP, BURLINGTON COUNTY, NEW JERSEY, SHEET #7.
  - MAP TITLED, "NATIONAL FLOOD INSURANCE PROGRAM, FIRM, FLOOD INSURANCE RATE MAP, BURLINGTON COUNTY, NEW JERSEY, (ALL JURISDICTIONS), PANEL 357 OF 641", MAP NUMBER 34005C0357F, EFFECTIVE DATE: DECEMBER 21, 2017.
  - MAP TITLED, "TAUNTON LAKE ROAD (C.R. 544 I), TOMLINSON MILL ROAD TO KINGS GRANT DRIVE/BARTON RUN BLVD, PARCEL E4, TOWNSHIP OF EVESHAM, BURLINGTON COUNTY", DATED DECEMBER 2022, PREPARED BY BURLINGTON COUNTY DEPARTMENT OF PUBLIC WORKS ENGINEERING OFFICE.

**BOUNDARY & PARTIAL TOPOGRAPHIC SURVEY**

**BLOCK 38**  
**LOTS 8.01, 9.01, & 10**

SITUATED IN  
**EVESHAM TOWNSHIP**  
**BURLINGTON COUNTY, NEW JERSEY**

PREPARED FOR  
**GREGORY & STEPHANIE FOX**  
**4 PLAZA WAY**  
**VOORHEES, NEW JERSEY 08043-4173**

**Carroll Engineering**  
SOMERSET COUNTY, NJ OFFICE  
105 RAIDER BOULEVARD, SUITE 206  
HILLSBOROUGH, NJ 08844  
PHONE: 908.874.7500  
FAX: 908.874.5762  
CORPORATE OFFICE: 630 Freedom Business Ctr., 3rd Fl.  
100 Easton Road, King of Prussia, PA 19866  
Phone: 610-572-7095  
433 Lancaster Avenue, Suite 200 Malvern, PA 19355  
Phone: 610-898-5100  
101 Larry Holmes, Suite 201 Easton, PA 18042  
Phone: 610-898-4900  
Certificate of Authorization: #24G12792100  
[www.carrolleengineering.com](http://www.carrolleengineering.com)  
CORPORATE ID: 2025-COR0014-ENG-00000000

DATE:	03/31/2025
CADD FILE:	24-5431-000-Survey.DWG
JOB NO:	24-5431-000
DSG BY:	N/A
DWN BY:	O.D.
CKD BY:	J.P.J.
SCALE:	1"=50'
DRAWER NUMBER:	
SHEET: 1 OF 1 SHEETS	
DRAWING NUMBER	200.4592

RYAN J. PATRICK  
PROFESSIONAL LAND SURVEYOR  
NJ LIC. NO. 24GSO4344400  
DATE: 03/31/2025

NO.	DATE	DESCRIPTION	INITIALS