



Guide for Installation Pools and Hot Tubs

Any structure intended for swimming, recreational bathing or wading that contains water over 24 inches (610 mm) deep requires a permit. This includes in-ground, above-ground and on-ground pools; hot tubs; spas and fixed-in-place wading pools. (Section 3109, IBC, NJ Edition/NEC)

If you plan to install any of the above structures, please review this guide in its entirety as it includes important information regarding installation requirements.

When submitting an application to erect or construct a private swimming pool/hot tub/etc., both Zoning and Construction Permits shall be required as follows:

For Zoning Review:

- 1) Completed zoning permit application with \$50.00 check made payable to the Township of Evesham.
- 2) The most recent survey for the property showing the proposed location of the pool, hot tub, etc. and all associated improvements as well as the location of the proposed fence or existing fence if installing a pool (see "Survey" for details below). Further information on pool barrier fence requirements may be found Swimming Pool Etiquette – 2020 Edition (NJ DCA's Construction Code Communicator Summer 2020) in this packet.
- 3) A completed Impervious (Building and Lot) Coverage Worksheet must be submitted unless this information is included as part of a topographical/grading plan.
- 4) **For in-ground pools only**, two sealed copies of a topographical or grading plan survey (see "Survey" for details below) and a \$500.00 check made payable to the Township of Evesham for grading plan review by the Township Engineer along with the Agreement to Pay Fees and W-9 forms found in this packet.

For Construction Review:

- 1) Completed UCC (construction) permit application folder, required subcode technical forms relevant to your project, and safety barrier information as follows:
 - For above ground pool using a ladder as a safety barrier: provide specifications on locking ladder
 - For hot tubs/spas: provide specifications on locking safety cover
 - For above ground pool or in-ground pool using a fence as a safety barrier: provide fence height, style, design and specifications for the proposed new fence including a picture or copy of the fence design brochure. The survey must clearly indicate whether any existing fencing is on the property on which the pool is being installed. Please note that new pool barrier fences must be installed at least 4' from any existing climbable fences on neighboring properties (see Swimming Pool Etiquette – 2020 Edition)

UCC fees will be determined after application is reviewed and approved.

Survey:

On the most recent survey, show the location and size of the pool/hot tub and all associated improvements. Indicate the distance from the edge of the improvement to all lot lines. For

example, measure from the edge of the pool's concrete apron, pavers, decking, hardscaping, waterfalls, diving boards, pumps, pool house pump enclosure, filters, etc. to the lot lines. The minimum distance required in all zoning districts is 15' from the edge of the improvement (*including* pool decking/concrete) to the property lot line and 5' from the pool equipment to the property lot line.

In-ground pool applications must be accompanied by (2) topographical/grading plan surveys indicating elevation of pool and proposed grading of the surrounding areas, whether disturbed or not, showing drainage pattern. This *must* be prepared, signed and sealed by a professional engineer.

Retaining Walls

If retaining walls are proposed or required, indicate their location on the survey and submit construction detail plans with elevations.

Fences for In-Ground Pools and Above Ground Pools Without Locking Ladder:

On the survey, show location of any fence *whether or not the fence is under your contract*. Please note that all pool fences and pool access safety devices are inspected under the most recent IRC or IBC Codes as adopted by the State of New Jersey.

Please note: If pool compliant fence is not currently installed on the property application for installation of the fence must be made at the same time as application for the pool. If the fence is the responsibility of the pool contractor, then it must be listed on the Building Subcode Technical form; otherwise a separate Building Subcode Technical form must be completed by either the homeowner or fence contractor and submitted. This Building Subcode form will be incorporated into the construction permit for the pool as an update.

Applications without the proper fence information/subcode form will be considered as incomplete and review will not commence until all information required is received.

We highly encourage that all applicants review Swimming Pool Etiquette – 2020 Edition (NJ DCA's Construction Code Communicator Summer 2020) enclosed in this packet regarding pool barriers.

Temporary Fence: A sturdy temporary fence with locking gate (if a gate is installed) must be in place around excavations deeper than 24" inches at all times during and after construction. If fences are not in place during progress inspections, the pool installer) will be subject to a monetary penalty.

Prior to Use of Pool:

- 1) A list of required inspections will be provided at the time of payment for the construction permit. **All** final inspections shall be performed and approved including but not limited to building, electrical and mechanical inspections. *Be please aware that fence/pool barrier is considered a life safety issue. For the safety of your family and others in your community it is important this inspection be completed and that the fence be to code.*
- 2) A Certificate of Approval will be issued once inspections are completed as long as any

prior approval requirements are met (if applicable). Certificates of Approval are mailed directly to the homeowner within (20) business days of the approved final inspections.

- 3) If an escrow payment was made for Township Engineer review of a grading plan, a request in writing for the return of any remaining escrow money may be made upon receipt of the Certificate of Approval.

NOTE TO HOMEOWNERS:

Final payment to contractors should NOT be made until all final inspections are completed and a Certificate of Approval is issued from this office. If the pool is used prior to passing final inspections a \$2,000.00 penalty may be issued

Notice for Zoning Approval:

Ordinance 62-62 requires that in no case shall any swimming pool or appurtenance be closer than fifteen (15) feet to any lot line. This distance shall be measured from the side and rear property lines to the edge of the concrete apron/decking or any improvement connected to the pool. The pool filter/heater must also be placed at least five (5) feet from all property lines.

Once the pool is installed, discharge water from the pool may not flow overland across lot lines.

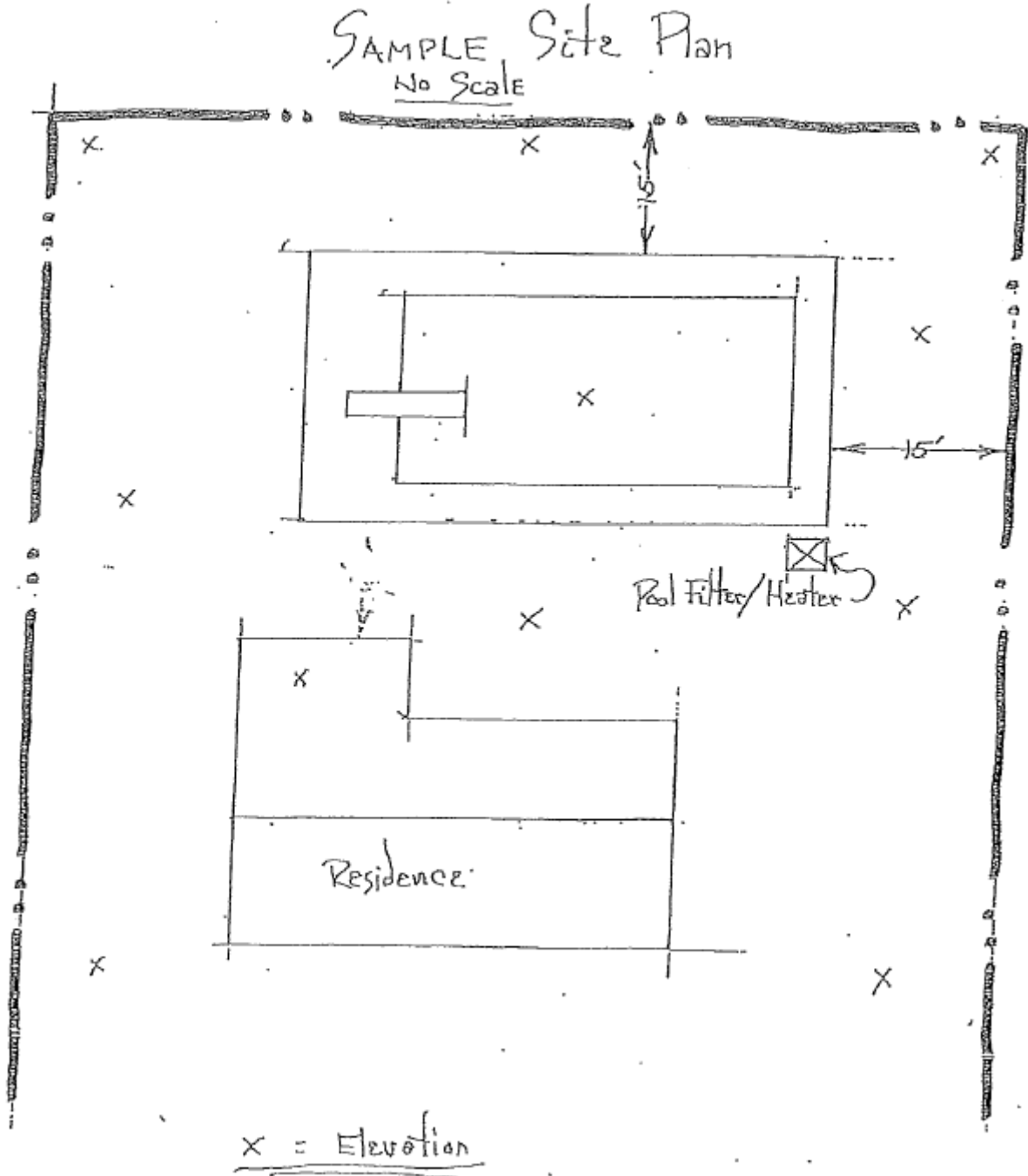

Swimming Pool Etiquette – 2020 Edition

Ok, here it is . . . the official scoop on all you've ever wanted to know about the Uniform Construction Code (UCC) requirements applicable to private swimming pools. Specifically, this article explains provisions for swimming pool depths, materials, barriers, and electrical requirements. Identifying the point at which a swimming pool is regulated by the 2018 edition of the International Building & Residential Code (IBC & IRC) and the Building Subcode & One- and Two-Family Dwelling Subcode has been confusing for several enforcing agencies. This article should clarify these uncertainties.

Definition/Application:

Sections 3109 of the 2018 IBC and Section R326 of the 2018 IRC require that all swimming and bathing facilities be regulated by the 2018 International Swimming Pool & Spa Code (ISPSC), except for those that are 24 inches or less in depth. This is based on the definition of "Swimming Pools" at Section 202 of the 2018 IBC; see explanation/application of this definition on page 1 within the article, "Above Ground Swimming Pools - Ladders with Attached Gates."

Barrier:

"Barrier" is defined at Section 202 of the 2018 ISPSC as "a permanent fence, wall, building wall, or combination thereof that completely surrounds the pool or spa and obstructs the access to the pool or spa. The term 'permanent' shall mean not being able to be removed, lifted, or relocated without the use of a tool." The requirements for a swimming pool barrier can be found at Section 305 of the 2018 ISPSC and modifications to the barrier requirements are noted at Section 3109/R326 of the 2018 IBC/IRC:

* Section 305.1, General, deletes the allowance for swimming pools to use a powered safety cover that complies with ASTM F1346 as a barrier.

* Section 305.4, Structure wall as a barrier, is deleted because it is redundant. If a wall of the home/building meets the other criteria of Section 305, it should be allowed as a barrier,

* Section 305.5, On ground residential pool structure as a barrier, in Item 3, deletes the allowance of removable ladder or "flip-up" stairs to be used as a barrier. At a minimum, for example, a 48" on-ground pool would require a barrier around the access ladder/stair.

A swimming pool barrier may be placed anywhere up to the property line, provided a local ordinance does not say otherwise, and as long as the pool is completely surrounded. As written, the barrier must be independent of any neighboring barrier and neighboring barriers are not to be shared for purposes of meeting pool barrier requirements.

Two conforming pool barriers may be placed back to back, provided the barriers are not climbable from either side. However, if a neighboring property contains a climbable fence or barrier, the barrier for the new pool should be placed a sufficient distance away in order to limit access to the pool. This distance should be based upon the topography of the properties. Separation distances between the fence and the barrier may range from two feet to four feet. Smaller or greater ranges may be appropriate, based upon specific circumstances.

However, it was determined back in the Winter 2008 edition of the Construction Code Communicator (and republished Winter 2017) that it is permissible to share a swimming-pool barrier, provided the local authority having jurisdiction grants a variation to do so. The variation should include a statement from the fence owner acknowledging use of his fence as a swimming-pool barrier and a statement from the pool owner acknowledging his responsibility to install a compliant barrier should the neighbor remove his fence for any reason.

The barrier should not be climbable, as per code, from the side away from the swimming pool; and if there is a swimming pool on both sides of the barrier, the barrier should not be climbable from either side.

Electrical:

The Code Assistance Unit has also encountered some confusion about whether an electrical permit is required for the installation of a swimming pool. Typically, there are two scenarios that would trigger the need for an electrical permit: [1a] if a swimming pool is capable of holding water to a depth of greater than 42 inches, OR [1b] a pool has nonmetallic, molded polymeric walls or inflatable fabric walls, regardless of dimension (definition of Storable Pool at Article 680 of the National Electrical Code/2017); or [2] if a swimming pool is equipped with permanent recirculation equipment, regardless of dimension.

Permits:

In short, it should be assumed a permit application is required to install any pool. Also, note that requirements for building, electrical and plumbing components are independent may require separate tech sections, as applicable. For example:

(continued on next page)

(Swimming Pool Etiquette – 2020 Edition)

- Building tech section required for pool that can contain water over 24 inches deep; this is not material specific (see definition for “on-ground pool” in the 2018 ISPSC).
- Electrical tech section required. However, if on-ground with nonmetallic, molded polymeric or inflatable walls, not required if all of the following conditions are met:
 - Motor/filtration pump unit is portable (no foundation/not bolted down) and can be readily disassembled from the water circulation system;
 - Motor/filtration pump unit is listed (UL, etc.) as double insulated and has a cord with a minimum of 25 feet in length;
 - Pool is capable of holding water to a maximum depth of 42 inches; and
 - Pool has no underwater lighting.

And as a friendly reminder, swimming pools receive a Certificate of Approval (not a Certificate of Occupancy). In addition, please see these related swimming pool articles:

- Swimming Pools and Spas – Plan Review & Inspections (page 7, Winter 2019 edition)
 - RE: Entrapment hazards; Pool barriers; and Bonding/grounding
- Pool Construction and Equipotential Bonding (page 15, Fall 2019 edition)
 - RE: Structural reinforcing steel in a conductive pool shell

Source: Rob Austin
Code Assistance/Development Unit
(609) 984-7609



Pool Fence Requirements

Above ground pools

Barrier are required for above ground pools, a removable ladder is not an acceptable barrier for an above ground pool. The barrier may be a compliant fence that surrounds the entire pool or yard. Pools that have a wall that is at least 48" do not require a fence around the entire pool and may have a fence just around the ladder area or a ladder with a built in self closing latching gate.

Above ground pools with walls at least 48" above grade



Ladder with built-in gate



Fence around ladder area

Fences with horizontal rails less than 45" apart

Where the barrier is composed of horizontal and vertical members and the distance between the tops of the horizontal members is less than 45 inches, the horizontal members shall be located on the swimming pool side of the fence. Spacing between vertical members shall not exceed 1-3/4 inches in width. Decorative cutouts shall not exceed 1-3/4 inches in width.

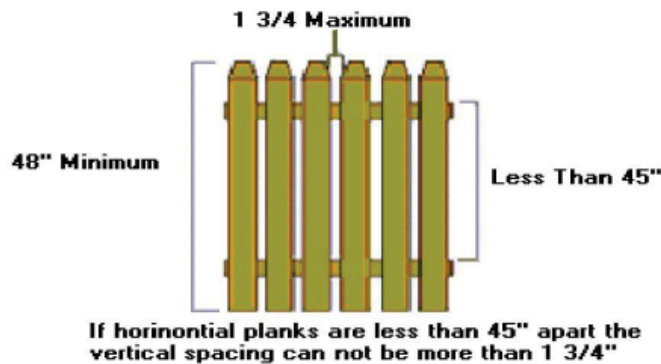

Fences with horizontal rails more than 45"aparts

Where the barrier is composed of horizontal and vertical members and the distance between the tops of the horizontal members is 45 inches or more, spacing between vertical members shall not exceed 4 inches. Decorative cutouts shall not exceed 1-3/4 inches in width.

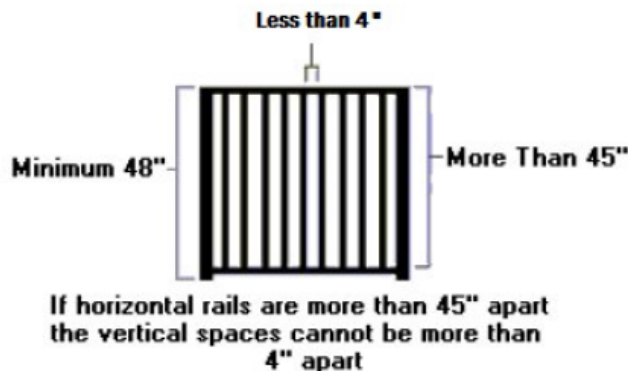

Chain link Fence Mesh Size Limit

Maximum mesh size for chain link fences shall be a 1 ¼-inch square unless the fence is provided with slats fastened at the top or the bottom which reduce the openings to not more than 1 ¾-inches. (Figure 3)

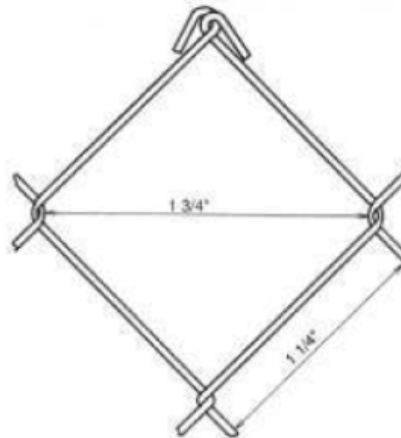

Important: The maximum mesh size for a pool fence is smaller than the standard chain link mesh

Gate Swing

Gates shall comply with the requirements of a fence for height, picket spacing or chain link mesh size and shall be equipped to accommodate a locking device. Pedestrian access gates shall open outwards away from the pool and shall be self-closing and have a self-latching device. Gates must swing out only so that even if the gate is not completely latched, a young child pushing on the gate in order to enter the pool area will at least close the gate and may actually engage the latch.

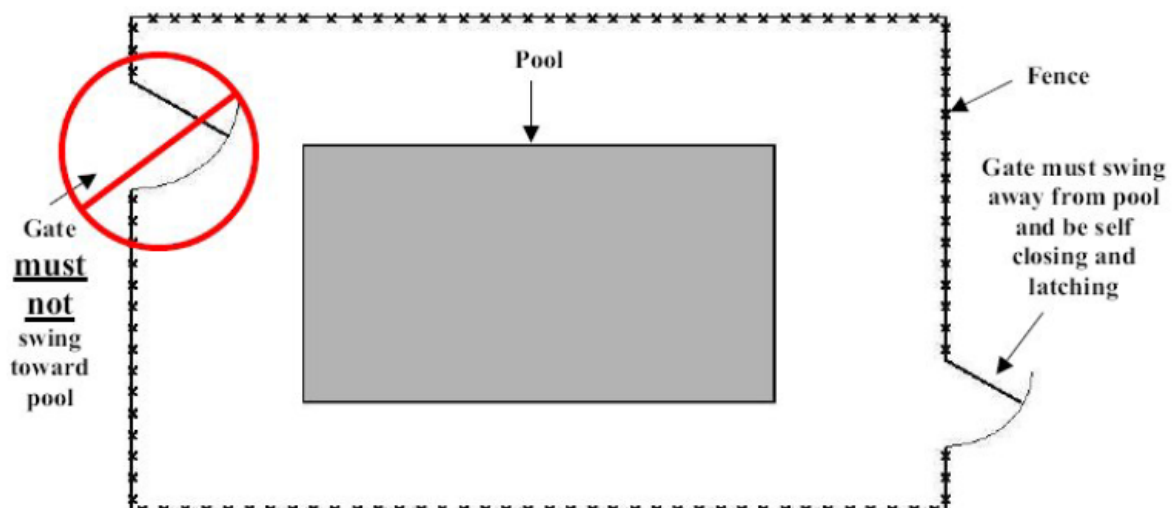

48" high gates with latches mounted less than 54" from the ground

If the latch is mounted less than 54" from grade, it must be mounted on the pool side of the gate, a minimum of 3" down from the top of the gate so you must reach over the fence to unlatch and have no space greater than 1/2" within 18" of the latch so a child can not reach through the fence to unlatch it.

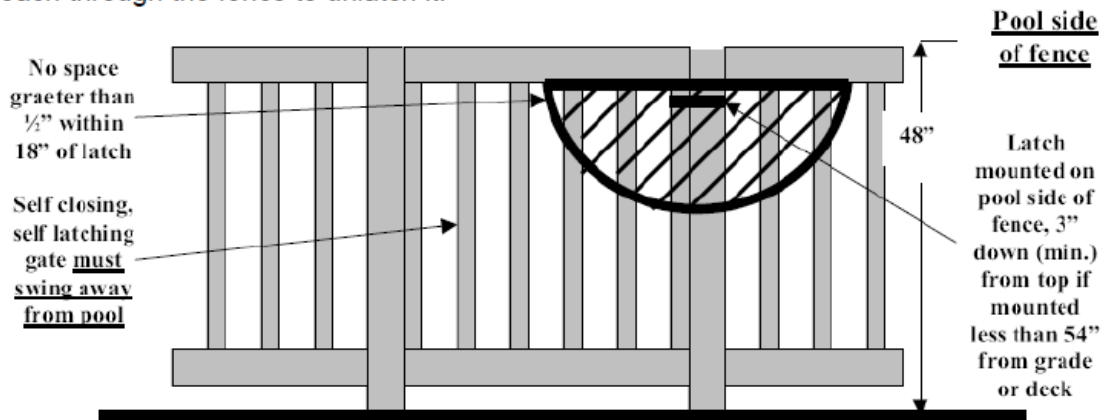

48" high gates with the latch mounted above the top of the gate.

Several manufactures make latches that can be mounted on a 48" high gate and have the operating mechanism above the top of the gate. The operating mechanism must be mounted at least 54" above the bottom of the gate.

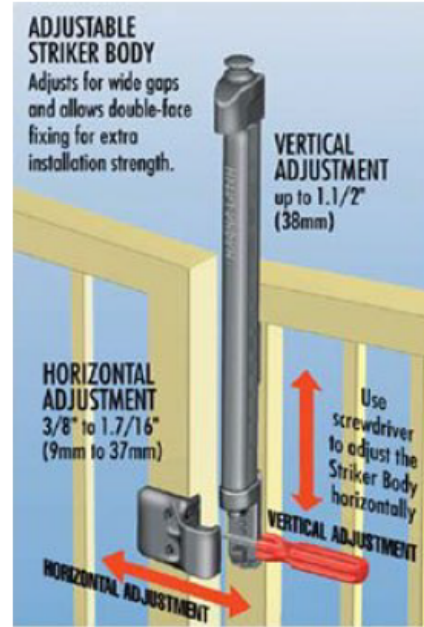

Gates more than 48" high

Gates that are more than 48" high must have the latch mounted at least 54" above the bottom of the gate.



2020 NEC ABOVE GROUND POOL HANDOUT

Required #8 solid copper equipotential bond conductor must follow the entire contour of the pool. Only listed splices shall be permitted. The conductor shall be 18"-20" from the walls of the pool. The conductor shall be 4"-6" below grade. The bond shall be connected to the pool frame in four areas. When the frame of the pool is of non-conductive material the walls of the pool must be bonded where the two seam of the walls are bolted together. The pump motor shall also bond to the pool frame with a #8 wire. Art 680.26(B)(C).

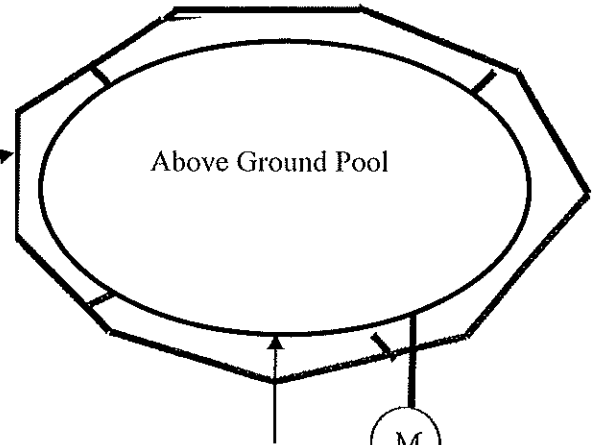

A UL listed water bond fitting must be installed in the skimmer box or in the water pipe to the pump motor.

Pump with not more than 3" of #12 cord

All conductors shall be copper. All outdoor receptacles covers shall be in-use (bubble cover) weatherproof type. #12 NM cable(romex) is a permitted wiring method inside of the dwelling only.

A timer must be installed according to 2018 IECC R 403.10.2

General purpose GFI protected receptacle located between 6' and 20' from pool. The receptacle must be a WR type. The words WR will be stamped on the face of the receptacle 680.22(A)1-4

3/4 electrical PVC conduit and fittings. The burial depth is a minimum of 18". Conductors must be black, white, and green, minimum #12 Type THHN copper on a dedicated 20 AMP circuit.

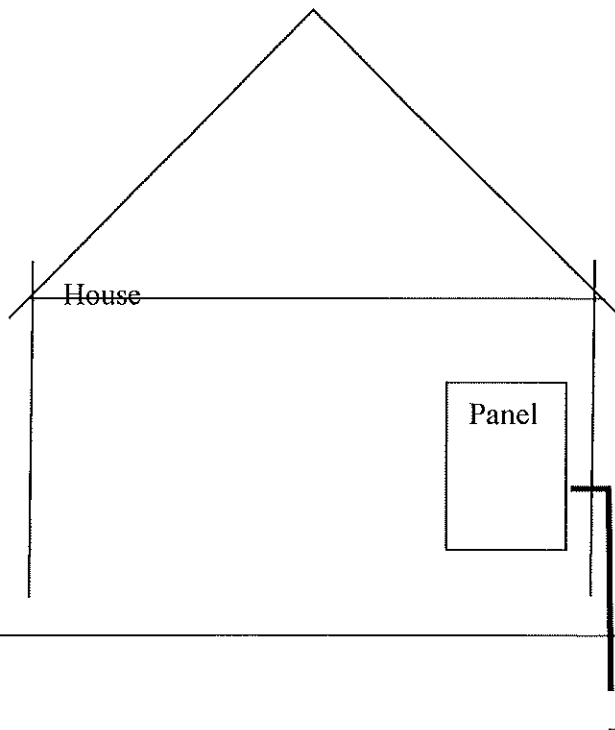

APPENDIX G

SWIMMING POOLS, SPAS AND HOT TUBS

SECTION AG101 GENERAL

AG101.1 General. The provisions of this appendix shall control the design and construction of swimming pools, spas and hot tubs installed in or on the *lot* of a one- or two-family dwelling.

AG101.2 Pools in flood hazard areas. Pools that are located in flood hazard areas established by Table R301.2(1), including above-ground pools, on-ground pools and in-ground pools that involve placement of fill, shall comply with Sections AG101.2.1 or AG101.2.2.

Exception: Pools located in riverine flood hazard areas which are outside of designated floodways.

AG101.2.1 Pools located in designated floodways. Where pools are located in designated floodways, documentation shall be submitted to the *building official*, which demonstrates that the construction of the pool will not increase the design flood elevation at any point within the *jurisdiction*.

AG101.2.2 Pools located where floodways have not been designated. Where pools are located where design flood elevations are specified but floodways have not been designated, the applicant shall provide a floodway analysis that demonstrates that the proposed pool will not increase the design flood elevation more than 1 foot (305 mm) at any point within the *jurisdiction*.

SECTION AG102 DEFINITIONS

AG102.1 General. For the purposes of these requirements, the terms used shall be defined as follows and as set forth in Chapter 2.

ABOVE-GROUND/ON-GROUND POOL. See "Swimming pool."

BARRIER. A fence, wall, building wall or combination thereof which completely surrounds the swimming pool and obstructs access to the swimming pool.

HOT TUB. See "Swimming pool."

IN-GROUND POOL. See "Swimming pool."

RESIDENTIAL. That which is situated on the premises of a detached one- or two-family dwelling or a one-family *townhouse* not more than three stories in height.

SPA, NONPORTABLE. See "Swimming pool."

SPA, PORTABLE. A nonpermanent structure intended for recreational bathing, in which all controls, water-heating and water-circulating *equipment* are an integral part of the product.

SWIMMING POOL. Any structure intended for swimming or recreational bathing that contains water over 24 inches (610 mm) deep. This includes in-ground, above-ground and on-ground swimming pools, hot tubs and spas.

SWIMMING POOL, INDOOR. A swimming pool which is totally contained within a structure and surrounded on all four sides by the walls of the enclosing structure.

SWIMMING POOL, OUTDOOR. Any swimming pool which is not an indoor pool.

SECTION AG103 SWIMMING POOLS

AG103.1 In-ground pools. In-ground pools shall be designed and constructed in conformance with ANSI/NSPI-5 as listed in Section AG108.

AG103.2 Above-ground and on-ground pools. Above-ground and on-ground pools shall be designed and constructed in conformance with ANSI/NSPI-4 as listed in Section AG108.

AG103.3 Pools in flood hazard areas. In flood hazard areas established by Table R301.2(1), pools in coastal high hazard areas shall be designed and constructed in conformance with ASCE 24.

SECTION AG104 SPAS AND HOT TUBS

AG104.1 Permanently installed spas and hot tubs. Permanently installed spas and hot tubs shall be designed and constructed in conformance with ANSI/NSPI-3 as listed in Section AG108.

AG104.2 Portable spas and hot tubs. Portable spas and hot tubs shall be designed and constructed in conformance with ANSI/NSPI-6 as listed in Section AG108.

SECTION AG105 BARRIER REQUIREMENTS

AG105.1 Application. The provisions of this chapter shall control the design of barriers for residential swimming pools, spas and hot tubs. These design controls are intended to provide protection against potential drownings and near-drownings by restricting access to swimming pools, spas and hot tubs subject to this code.

AG105.2 Outdoor swimming pool. An outdoor swimming pool, including an in-ground, above-ground or on-ground pool, hot tub or spa shall be surrounded by a barrier which shall comply with the following:

1. The top of the barrier shall be at least 48 inches (1219 mm) above *grade* measured on the side of the barrier which faces away from the swimming pool. The maximum vertical clearance between grade and the bottom of the barrier shall be 2 inches (51 mm) measured on the side of the barrier which faces away from the swimming pool. Where the top of the pool structure is above grade, such as an above-ground pool, the barrier may be at

ground level, such as the pool structure, or mounted on top of the pool structure. Where the barrier is mounted on top of the pool structure, the maximum vertical clearance between the top of the pool structure and the bottom of the barrier shall be 4 inches (102 mm).

2. Openings in the barrier shall not allow passage of a 4-inch-diameter (102 mm) sphere.
3. Solid barriers which do not have openings, such as a masonry or stone wall, shall not contain indentations or protrusions except for normal construction tolerances and tooled masonry joints.
4. Where the barrier is composed of horizontal and vertical members and the distance between the tops of the horizontal members is less than 45 inches (1143 mm), the horizontal members shall be located on the swimming pool side of the fence. Spacing between vertical members shall not exceed 1³/₄ inches (44 mm) in width. Where there are decorative cutouts within vertical members, spacing within the cutouts shall not exceed 1³/₄ inches (44 mm) in width.
5. Where the barrier is composed of horizontal and vertical members and the distance between the tops of the horizontal members is 45 inches (1143 mm) or more, spacing between vertical members shall not exceed 4 inches (102 mm). Where there are decorative cutouts within vertical members, spacing within the cutouts shall not exceed 1³/₄ inches (44 mm) in width.
6. Maximum mesh size for chain link fences shall be a 2¹/₄-inch (57 mm) square unless the fence has slats fastened at the top or the bottom which reduce the openings to not more than 1³/₄ inches (44 mm).
7. Where the barrier is composed of diagonal members, such as a lattice fence, the maximum opening formed by the diagonal members shall not be more than 1³/₄ inches (44 mm).
8. Access gates shall comply with the requirements of Section AG105.2, Items 1 through 7, and shall be equipped to accommodate a locking device. Pedestrian access gates shall open outward away from the pool and shall be self-closing and have a self-latching device. Gates other than pedestrian access gates shall have a self-latching device. Where the release mechanism of the self-latching device is located less than 54 inches (1372 mm) from the bottom of the gate, the release mechanism and openings shall comply with the following:
 - 8.1. The release mechanism shall be located on the pool side of the gate at least 3 inches (76 mm) below the top of the gate; and

8.2. The gate and barrier shall have no opening larger than 1/2 inch (12.7 mm) within 18 inches (457 mm) of the release mechanism.

9. Deleted.
10. Where an above-ground pool structure is used as a barrier or where the barrier is mounted on top of the pool structure, and the means of access is a ladder or steps:
 - 10.1. Deleted.
 - 10.2. The ladder or steps shall be surrounded by a barrier which meets the requirements of Section AG105.2, Items 1 through 9.

AG105.3 Indoor swimming pool. Walls surrounding an indoor swimming pool shall comply with Section AG105.2, Items 1 through 7.

AG105.4 Prohibited locations. Barriers shall be located to prohibit permanent structures, *equipment* or similar objects from being used to climb them.

AG105.5 Barrier exceptions. Spas or hot tubs with a safety cover which complies with ASTM F 1346, as listed in Section AG107, shall be exempt from the provisions of this appendix.

SECTION AG106 ENTRAPMENT PROTECTION FOR SWIMMING POOL AND SPA SUCTION OUTLETS

AG106.1 General. Suction outlets shall be designed and installed in accordance with ANSI/APSP-7.

SECTION AG107 ABBREVIATIONS

- AG107.1 General.**
- ANSI—American National Standards Institute
11 West 42nd Street
New York, NY 10036
 - APSP—Association of Pool and Spa Professionals
 - NSPI—National Spa and Pool Institute
2111 Eisenhower Avenue
Alexandria, VA 22314
 - ASCE—American Society of Civil Engineers
1801 Alexander Bell Drive
Reston, VA 98411-0700
 - ASTM—ASTM International
100 Barr Harbor Drive,
West Conshohocken, PA 19428
 - UL—Underwriters Laboratories, Inc.
333 Pfingsten Road
Northbrook, IL 60062-2096

**SECTION AG108
STANDARDS**

AG108.1 General.

ANSI/NSPI

ANSI/NSPI-3-99 Standard for
Permanently Installed Residential Spas AG104.1

ANSI/NSPI-4-99 Standard for Above-ground/
On-ground Residential Swimming Pools. AG103.2

ANSI/NSPI-5-2003 Standard for
Residential In-ground Swimming Pools. AG103.1

ANSI/NSPI-6-99 Standard for
Residential Portable Spas AG104.2

ANSI/APSP

ANSI/APSP-7-06 Standard for Suction Entrapment
avoidance in Swimming Pools, Wading Pools, Spas,
Hot Tubs and Catch Basins. AG106.1

ASCE

ASCE/SEI-24-05 Flood Resistant
Design and Construction. AG103.3

ASTM

ASTM F 1346-91 (2003) Performance
Specification for Safety Covers and Labeling
Requirements for All Covers for Swimming Pools,
Spas and Hot Tubs AG105.2, AG105.5

UL

UL 2017-2000 Standard for General-purpose
Signaling Devices and Systems—with Revisions
through June 2004. AG105.2

LAND USE REGULATIONS

94 Attachment 4

Township of Evesham

Building and Lot Coverage Worksheet
[Added 12-15-2015 by Ord. No. 30-12-2015]

Block: Lot Zoning District

1. SQUARE FOOTAGE OF YOUR PROPERTY (1 ACRE = 43,560 S.F.) sq. ft.

Table with 3 columns: Building Coverage - Existing (house and attached additions), Dimensions, Square Feet. Rows include House, Attached Garage, Attached Deck, Other Attached, and Total existing building coverage.

Table with 3 columns: Lot Coverage - Existing (building coverage + impervious surfaces + accessory structures), Dimensions, Square Feet. Rows include Building coverage, Driveway, Walkways/patio, Detached garage(s), Decking, Shed, gazebo, greenhouse etc, Pool, Other, Total Existing Lot Coverage, and Total % of Existing Lot Coverage.

Table with 3 columns: Building Coverage - Proposed (Identify structure i.e. addition, deck, attached garage etc.), Dimensions, Square Feet. Rows 17 and 18 for additional proposed building coverage.

Table with 3 columns: Lot Coverage - Proposed (i.e. new patio, driveway, shed, pool), Dimensions, Square Feet. Rows 19 and 20 for additional proposed lot coverage.

- 21. Total Proposed Building and Lot Coverage (add lines 17 through 20)
22. Total Lot Coverage - Existing & Proposed (add lines 15 & 21)
23. Total % Lot Coverage (line 22 divided by line 1, then multiply by 100)
24. Total Building and Lot (Impervious) Coverage % permitted by code**

** The Zoning Officer will fill in this ratio



Township of Evesham.

<https://evesham-nj.org/>

984 Tuckerton Road • Marlton • NJ 08053 • 856-983-2914 • [Community Development](#) [Township Code](#)

D. AGREEMENT TO PAY FEES: This agreement, made and entered on ____ 20__, by and between the Township of Evesham, a Municipal Corporation of the State of New Jersey (hereinafter TOWNSHIP) and _____
_____ **homeowner** (hereinafter DEVELOPER), is made upon the following terms & conditions.

INFORMATION AND CONTACT/S: Entity responsible for escrow

Project Name: _____

Applicant Name: _____ **Escrow Contact Name:** _____

Applicant/entity name responsible for the escrow must match the name submitted on the W9

Phone #: _____ Email: _____

Applicant Mailing Address: _____

Notice: DEVELOPER agrees that all notices or refunds shall be mailed to the following address (note if different to above): _____

1. Agreement to Pay Fees: DEVELOPER hereby covenants and agrees to pay all charges and fees imposed by the TOWNSHIP in connection with the application for development filed contemporaneously herewith. Such fees include, but are not limited to, application fees, attorney review fees, engineer review fees planner review fees, copy costs and postage applicable to this application.

2. Escrow Deposit: TOWNSHIP hereby acknowledges receipt of \$_____, said sum being a cash deposit to be placed in a TOWNSHIP trust account to cover the cost of the aforementioned review and inspection fees. Such sum shall be charged periodically as fees and charges accrue and the balance of the escrow sum, if any, after all charges and fees have been paid shall be returned to DEVELOPER.

3. Additional Payments: The DEVELOPER agrees to pay any additional sum required to pay charges and fees not covered by the escrow deposit within fifteen (15) days after the date of receipt of a notice of deficiency by the appropriate Township Office. The DEVELOPER understand and agrees to pay such sum notwithstanding any dispute as to the reasonableness of the fees and charges.

4. Contest of Reasonableness: DEVELOPER agrees that the reasonableness and/or accuracy of any fee or charge may be challenged within seven (7) days of receipt of the professional's billing advice copy and in accordance with the Code of the Township of Evesham. DEVELOPER understands and agrees that the aforesaid procedures shall be the sole and exclusive method of challenging the reasonableness and/or accuracy of charges and fees and hereby waives any longer statute or limitations.

5. Notice: See Developer information and contact/s above

6. Transferability: DEVELOPER understands and agrees that this contract agreement is not transferable, in whole or in part, nor can the DEVELOPER relieve himself/herself from obligation as stated in this contract agreement until such time as said DEVELOPER provides an acceptable dated replacement contract agreement to relieve said DEVELOPER of any further obligation as stated in this contract agreement. This transfer of obligation shall commence on the later of the date of the acceptance by the TOWNSHIP of this replacement contract agreement.

7. Collection: Should the DEVELOPER fail to pay any amount required to be paid hereunder when due, TOWNSHIP shall be entitled to pursue all remedies at law or equity. Interest shall accrue at rate of 18% per annum simple interest on all sums unpaid after the due date. The TOWNSHIP may collect a reasonableness attorney fee which shall not be less than \$300.00 should litigation for the purpose of collecting any sum be commenced.

Signed Developer

Date

Request for Taxpayer Identification Number and Certification

**Give Form to the
 requester. Do not
 send to the IRS.**

Print or type See Specific Instructions on page 2.	1 Name (as shown on your income tax return). Name is required on this line; do not leave this line blank.	
	2 Business name/disregarded entity name, if different from above	
	3 Check appropriate box for federal tax classification; check only one of the following seven boxes: <input type="checkbox"/> Individual/sole proprietor or single-member LLC <input type="checkbox"/> C Corporation <input type="checkbox"/> S Corporation <input type="checkbox"/> Partnership <input type="checkbox"/> Trust/estate <input type="checkbox"/> Limited liability company. Enter the tax classification (C=C corporation, S=S corporation, P=partnership) ▶ _____ Note. For a single-member LLC that is disregarded, do not check LLC; check the appropriate box in the line above for the tax classification of the single-member owner. <input type="checkbox"/> Other (see instructions) ▶ _____	
	4 Exemptions (codes apply only to certain entities, not individuals; see instructions on page 3): Exempt payee code (if any) _____ Exemption from FATCA reporting code (if any) _____ <i>(Applies to accounts maintained outside the U.S.)</i>	
	5 Address (number, street, and apt. or suite no.)	Requester's name and address (optional)
	6 City, state, and ZIP code	
	7 List account number(s) here (optional)	

Part I Taxpayer Identification Number (TIN)

Enter your TIN in the appropriate box. The TIN provided must match the name given on line 1 to avoid backup withholding. For individuals, this is generally your social security number (SSN). However, for a resident alien, sole proprietor, or disregarded entity, see the Part I instructions on page 3. For other entities, it is your employer identification number (EIN). If you do not have a number, see *How to get a TIN* on page 3.

Social security number											
				-			-				
or											
Employer identification number											
				-							

Note. If the account is in more than one name, see the instructions for line 1 and the chart on page 4 for guidelines on whose number to enter.

Part II Certification

Under penalties of perjury, I certify that:

1. The number shown on this form is my correct taxpayer identification number (or I am waiting for a number to be issued to me); and
2. I am not subject to backup withholding because: (a) I am exempt from backup withholding, or (b) I have not been notified by the Internal Revenue Service (IRS) that I am subject to backup withholding as a result of a failure to report all interest or dividends, or (c) the IRS has notified me that I am no longer subject to backup withholding; and
3. I am a U.S. citizen or other U.S. person (defined below); and
4. The FATCA code(s) entered on this form (if any) indicating that I am exempt from FATCA reporting is correct.

Certification instructions. You must cross out item 2 above if you have been notified by the IRS that you are currently subject to backup withholding because you have failed to report all interest and dividends on your tax return. For real estate transactions, item 2 does not apply. For mortgage interest paid, acquisition or abandonment of secured property, cancellation of debt, contributions to an individual retirement arrangement (IRA), and generally, payments other than interest and dividends, you are not required to sign the certification, but you must provide your correct TIN. See the instructions on page 3.

Sign Here	Signature of U.S. person ▶	Date ▶
------------------	----------------------------	--------

General Instructions

Section references are to the Internal Revenue Code unless otherwise noted.

Future developments. Information about developments affecting Form W-9 (such as legislation enacted after we release it) is at www.irs.gov/fw9.

Purpose of Form

An individual or entity (Form W-9 requester) who is required to file an information return with the IRS must obtain your correct taxpayer identification number (TIN) which may be your social security number (SSN), individual taxpayer identification number (ITIN), adoption taxpayer identification number (ATIN), or employer identification number (EIN), to report on an information return the amount paid to you, or other amount reportable on an information return. Examples of information returns include, but are not limited to, the following:

- Form 1099-INT (interest earned or paid)
- Form 1099-DIV (dividends, including those from stocks or mutual funds)
- Form 1099-MISC (various types of income, prizes, awards, or gross proceeds)
- Form 1099-B (stock or mutual fund sales and certain other transactions by brokers)
- Form 1099-S (proceeds from real estate transactions)
- Form 1099-K (merchant card and third party network transactions)

- Form 1098 (home mortgage interest), 1098-E (student loan interest), 1098-T (tuition)
- Form 1099-C (canceled debt)
- Form 1099-A (acquisition or abandonment of secured property)

Use Form W-9 only if you are a U.S. person (including a resident alien), to provide your correct TIN.

If you do not return Form W-9 to the requester with a TIN, you might be subject to backup withholding. See What is backup withholding? on page 2.

By signing the filled-out form, you:

1. Certify that the TIN you are giving is correct (or you are waiting for a number to be issued),
2. Certify that you are not subject to backup withholding, or
3. Claim exemption from backup withholding if you are a U.S. exempt payee. If applicable, you are also certifying that as a U.S. person, your allocable share of any partnership income from a U.S. trade or business is not subject to the withholding tax on foreign partners' share of effectively connected income, and
4. Certify that FATCA code(s) entered on this form (if any) indicating that you are exempt from the FATCA reporting, is correct. See *What is FATCA reporting?* on page 2 for further information.